

**Planning
Retaining wall of the road S 294
in Langenreinsdorf**

C&E · Consulting und
Engineering GmbH



09117 Chemnitz • Jagdschänkenstraße 52
Tel.: +49 (0) 371 881 42 28 • Fax: +49 (0) 371 881 43 11
E-mail: info@cue-chemnitz.de
Internet: www.cue-chemnitz.de

Project objective: Embankment protection by replacement construction as drilling pile diaphragm

Location: Langenreinsdorf bei Crimmitschau

Client/Beneficiary: SBA Zwickau

Year: 2003

Costs: 250.000 €

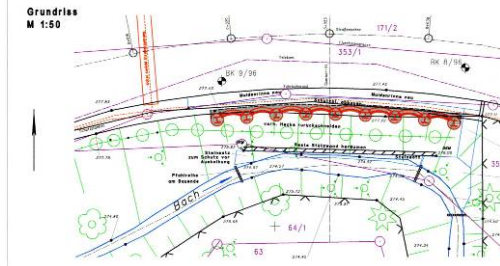

Project services:

**Detail Schnitt A-A
M 1:25**

Spritzbetonschale
C 30/37
auf Bewehrung
Q 513

Bohrpfahl
Pfahlbeton C 30/37
mit eingelegtem
Stahlträger
HEA 300
als Bewehrung
Bohrrohr wird
abschließend gezogen

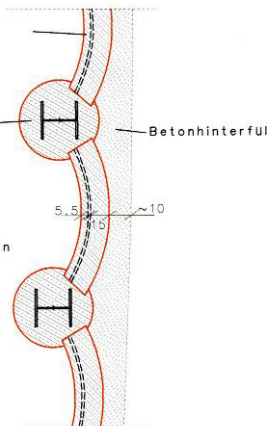

Work phases

- Preliminary planning
- Final design
- Diversion planning
- Cost estimation of individual variants agreements with some media agencies

Contents

- Survey of damage of the existing retaining wall and the already marked damages of the street in the inside curve region
- Investigations of variants, preferred solution with berlin type pit lining
- Constructive agreements, construction design
- Calculation of quantities for the tendering documents
- Service description