

**Watergate construction
for navigable connection between
Senftenberger sea and
Geierswalder sea**

C&E · Consulting und
Engineering GmbH



09117 Chemnitz; • Jagdschänkenstraße 52
Tel.: +49 (0) 371 881 22 39 • Fax: +49 (0) 371 881 45 89
E-mail: info@cue-chemnitz.de
Internet: www.cue-chemnitz.de

Project Objective: Technical Assistance for navigable connection between Senftenberger and Geierswalder seas

Location: Senftenberg

Client: Lausitz and Central-German Mining Administration Company „LMBV mbH“

Beneficiary: Lausitz and Central-German Mining Administration Company „LMBV mbH“

Duration: 2006-2008

Investment: approx. 3,2 Mio €

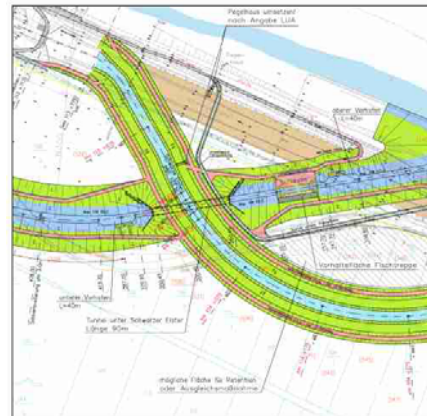

For the overcoming of the difference in height of 4 m between Senftenberger sea and Geierswalder sea, a watergate with an effective length of 47.5 m has been constructed. For the soil improvement the gravel pad under the watergate construction is planned.

The objectives of these measures were water touristy use as well as increase of reuse standards in the brown coal areas.

Watergate construction for navigable connection between Senftenberger sea and Geierswalder sea

C&E · Consulting und
Engineering GmbH



09117 Chemnitz; • Jagdschänkenstraße 52
Tel.: +49 (0) 371 881 22 39 • Fax: +49 (0) 371 881 45 89
E-mail: info@cue-chemnitz.de
Internet: www.cue-chemnitz.de

Services provided:

- Planning and support structure planning work phases 3 to 7 acc. to Fee Structure for Architects and Engineers

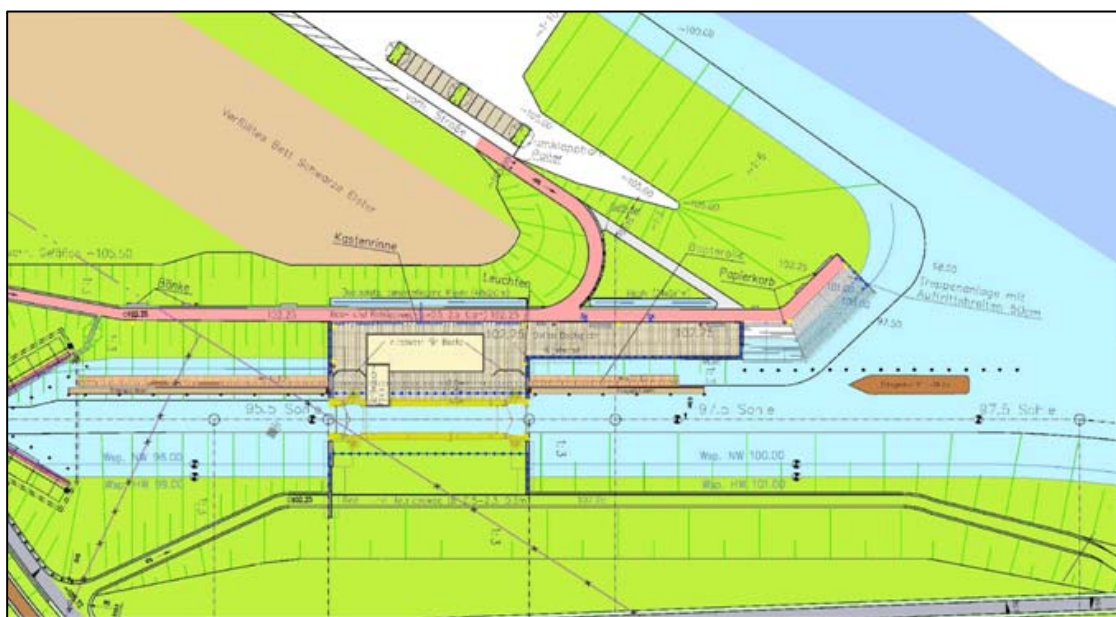

Watergate construction for navigable connection between Senftenberger sea and Geierswalder sea

C&E · Consulting und
Engineering GmbH



09117 Chemnitz; • Jagdschänkenstraße 52
Tel.: +49 (0) 371 881 22 39 • Fax: +49 (0) 371 881 45 89
E-mail: info@cue-chemnitz.de
Internet: www.cue-chemnitz.de

Planning services

- Engineering work: watergate constructions with administration building and free areas (sluice length: 47.50 m, lift: 4.50 m)
- Water touristy facilities: slipways, offshore terminals and landing stages
- Traffic facilities, road connections in the watergate area

Planning of structural framework

- Watergate construction
- Footway bridge
- Landing stage in head and tail water

Steel construction for hydraulic engineering/electro-magnetic compatibility¹

- Water civil engineered equipment: lock gate, piping and valve for sluice operation and spillway
- Electro-technics and process measuring and control technology: energy supply and illumination, measurement and control engineering, technical equipment for the increased corrosion prevention of steel parts

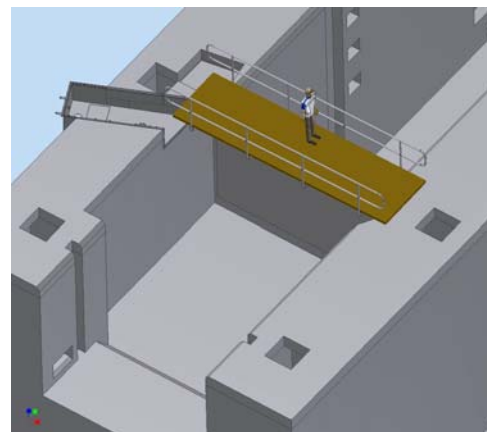
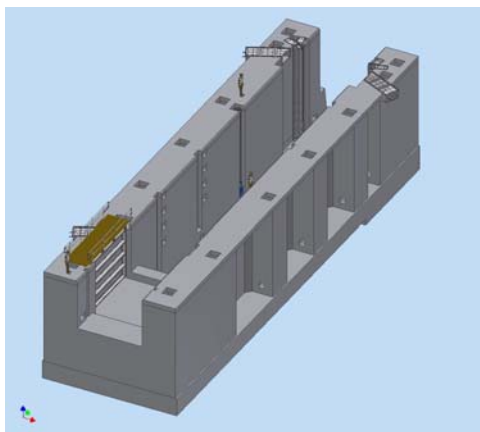

¹ Planning of steel construction for hydraulic engineering/electro-magnetic compatibility¹ is carried out by consulting company Döhler (Neustrelitz)