

Water Treatment Plant Ronneburg

C&E · Consulting und
Engineering GmbH



D-09117 Chemnitz • Jagdschänkenstraße 52
Tel.: +49 (0) 371 881 22 39 • Fax: +49 (0) 371 881 45 89
E-mail: info@cue-chemnitz.de
Internet: www.cue-chemnitz.de

Project objective: Planning of a water treatment plant including supply and delivery pipes

Location: Ronneburg, Thuringia

Client: UIT GmbH, Linde KCA

Beneficiary: Wismut GmbH

Duration: 2000-2003

Investment costs: 7.500.000 €

Initial Situation:

In the underground mining area Ronneburg remediation measures have been carried out. Starting from 2002 and over a period of approx. 30 years the incoming contaminated flood water (up to approx. 600 m³/h), which are emitted at various points should be collected and cleaned in the water treatment plant and be discharged in the "Weißer Elster".

Location

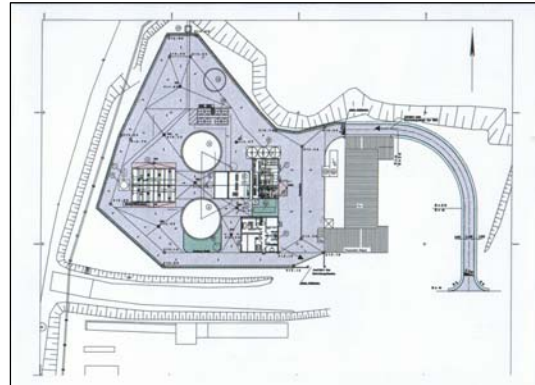

Drainage shaft

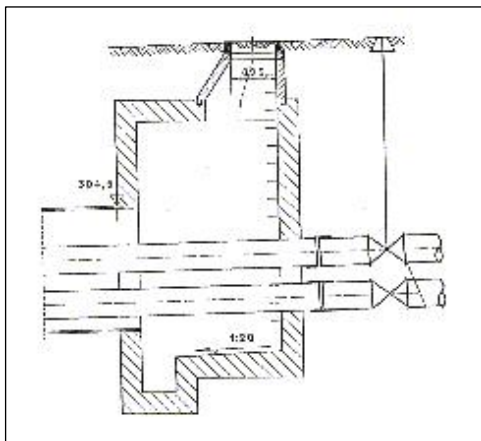

Project services:

- Planning of the engineering works § 55 Fee Structure for Architects and Engineers service phases 2-6
- Planning of structural framework § 67 Fee Structure for Architects and Engineers service phases 3-6
- Soil investigation report, foundation consulting
- Shaft water supply 3.2 km as a pump pressure line PE-HD Da 355 mm double-walled
- Pump station with receiver tank from ferroconcrete, pump capacity 200 kW
- Water discharge 10 km pressure line PE-HD Da 355-450 mm with channel crossing, water crossing and street crossing
- Water Treatment Plant (6000 m²) with traffic facility, technical design (machinery hall, ferroconcrete thickener, filtration station, neutralisation basins, administration building)